

# How to connect Your Wii to the Internet non-wirelessly



©2009 Nintendo

We'll review the simple steps required to connect your Nintendo Wii to the Internet using the powerlines in your home.

## Step 1

Get the Actiontec Powerline Gaming Kit that includes two Powerline Ethernet Adapters.



## Step 2

Find your Broadband Modem/ Router. Plug one end of the 1st Ethernet Cable into the Ethernet Port on the bottom of the 1st Powerline Ethernet Adapter.



## Step 3

Plug the Powerline Adapter into a Power Outlet. Do NOT plug the Adapter into a power strip or wall outlet that uses surge protection as the Adapter may not work



## Step 4

Plug the other end of the Ethernet Cable into an OPEN Ethernet Port on your Modem/ Router. An Ethernet port looks similar to a phone port but is slightly larger.



## Step 5

Find your Nintendo Wii. Make sure the USB to Ethernet Adapter is plugged into the Ethernet Port.



## Step 6

Plug one end of the 2nd Ethernet Cable into the Ethernet Port on the bottom of the 2nd Powerline Ethernet Adapter.



## Step 7

Plug the Powerline Adapter into a Power Outlet. Do NOT plug the Adapter into a power strip or wall outlet that uses surge protection as the Adapter may not work.



## Step 8

Plug the other end of the Ethernet Cable into the Ethernet Port on Wii USB to Ethernet Adapter.



## Step 9

Select the "Wii Options" button on the Wii menu by pressing the "A" on the Wii remote when the hand is over the "Wii Options" button.

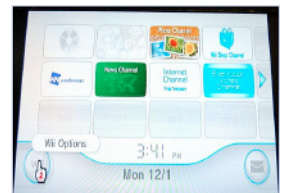

## Step 10

Select the "Wii Settings" button.



continued on the next page ▶

## How to connect Your Wii to the Internet non-wirelessly

By Lesley Kirchman

continued from the previous page

### Step 11

Select the "Internet" button.

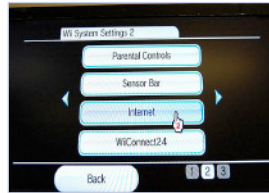

### Step 12

Select the "Connection Settings" button.

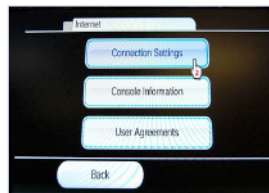

### Step 13

Select the "Connection 2" button



### Step 14

Select the "Wired Connection" button.



### Step 15

Select the "OK" button.



### Step 16

Select the "Use this Connection" button.

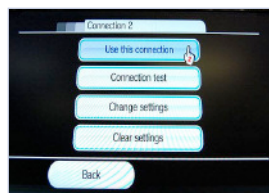

### Step 17

You'll see Connection 2 set up as Wired. Select the "Back" key on the screen or the "House" button on the remote to return to the main Wii Menu. You should now be connected to the Internet using HomePlug (aka Powerline) Technology.



**Hint:** Do NOT plug the Adapter into a power strip or wall outlet that uses surge protection as the Adapter may not work.